

## OC 3 Mobile Outdoor Cleaner

English

3

### Operating Instructions

Please read the operating instructions carefully before using the unit.





**Register and win!**  
[www.kärcher.com/register-and-win](http://www.kärcher.com/register-and-win)

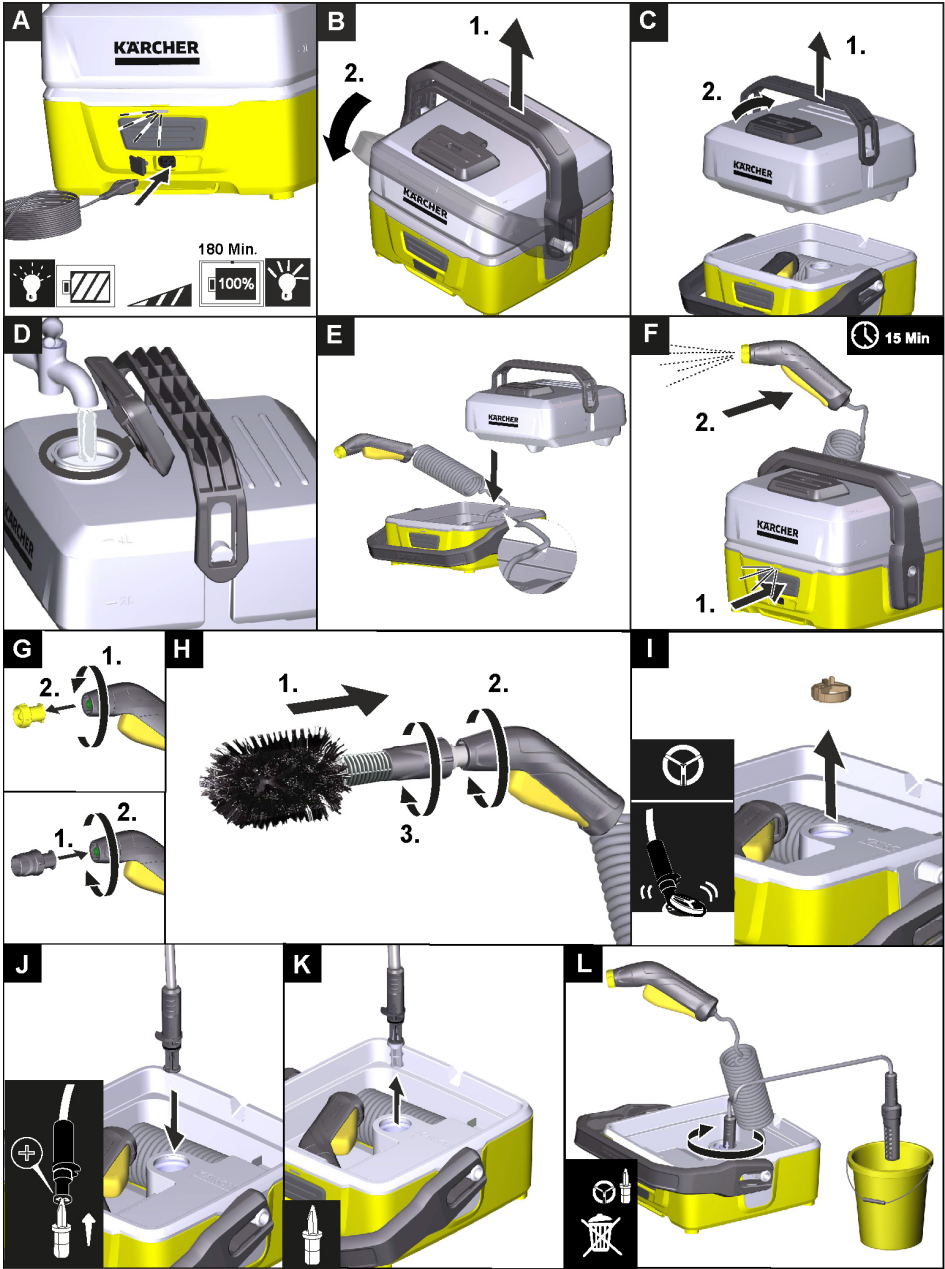



## Contents

|                              |    |   |
|------------------------------|----|---|
| Safety                       | EN | 1 |
| Proper use                   | EN | 3 |
| Safety Devices               | EN | 3 |
| Environmental protection     | EN | 3 |
| Description of the Appliance | EN | 4 |
| Scope of delivery            | EN | 5 |
| Start up                     | EN | 5 |
| Operation                    | EN | 5 |
| Transport                    | EN | 6 |
| Storage                      | EN | 6 |
| Care and maintenance         | EN | 6 |
| Troubleshooting              | EN | 6 |
| Warranty                     | EN | 6 |
| Technical specifications     | EN | 7 |
| Accessories and Spare Parts  | EN | 7 |

  Please read these original operating instructions and the enclosed safety instructions prior to the initial use of your device. Proceed accordingly. Keep both booklets for future reference or subsequent owners.

## Safety

### Symbols on the machine



#### **⚠ WARNING**

Charge the battery with the enclosed original charger or a charger approved by KÄRCHER only.

### Danger or hazard levels

#### **⚠ DANGER**

Pointer to immediate danger, which leads to severe injuries or death.

#### **⚠ WARNING**

Pointer to a possibly dangerous situation, which can lead to severe injuries or death.

#### **⚠ CAUTION**

Pointer to a possibly dangerous situation, which can lead to minor injuries.

## ATTENTION

Pointer to a possibly dangerous situation, which can lead to property damage.

## Charger

### **⚠ DANGER**

*Risk of electric shock.*

- Never touch the mains plug and the socket with wet hands.
- Do not use the charger if dirty or wet.
- Do not operate the charger in explosive environment.
- Do not carry the charger by holding the mains cable.
- Protect the mains cable against heat, sharp edges, oil and moving parts of the machine.
- Avoid using extension wires with multiple sockets and simultaneous operation of multiple devices.
- Do not pull the plug from the socket by pulling the mains cable.
- Do not cover the charger and keep the air vents of the charger open.
- No metal parts should come in contact with battery holders; risk of short circuit.
- Do not open the charger. Get repairs done only by authorised experts.
- Use the charger only to charge approved battery packs.
- Do not charge battery (primary cells); risk of explosion.

- *Do not charge the battery pack for longer than 24 hours, continuously.*
- *Do not insert conductive objects (such as screwdrivers or the like) into the charging socket.*
- *You may recharge the battery using only the original charger provided with the appliance or a charger approved by KÄRCHER.*
- *Immediately replace the charger with the charging cable in case of visible damage.*
- *The appliance contains electrical components - do not clean under running water.*
- *Store and use the charger in dry rooms only, ambient temperature 5 - 40 °C.*
- *The appliance may not be operated in explosive atmospheres.*
- *If the appliance is used in hazardous areas the corresponding safety provisions must be observed.*
- *Do not use the appliance if it fell down, is visibly damaged or leaking.*
- *Never use the appliance to clean objects containing hazardous substances (e.g. asbestos).*
- *Do not fill in detergents or other additives!*

**⚠ WARNING**

- *The appliance must not be operated by children or persons who have not been instructed accordingly.*
- *This appliance is not intended for use by persons with limited physical, sensory or mental capacities or lacking experience and/or skills, unless such persons are accompanied and supervised by a person in charge of their safety or they have received precise instructions on the use of this appliance and have understood the resulting risks.*
- *Children must not play with this appliance.*
- *Supervise children to prevent them from playing with the appliance.*
- *Operate or store the appliance only in accordance with the description or illustration!*

## Battery

**⚠ DANGER**

*Risk of electric shock.*

- *Do not insert conductive objects (such as screwdrivers or the like) into the charging socket.*
- *Do not expose the battery to direct sunlight, heat or fire.*

## Safe handling

**⚠ DANGER**

- *The user must use the appliance as intended. The person must consider the local conditions and must pay attention to other persons in the vicinity when working with the appliance.*

- *Only switch on the device when water is present in the water reservoir. Dry running may damage the device.*
  - *Do not direct the spray jet at the eyes.*
- ⚠ CAUTION**
- *Never fill solvents, solvent-containing liquids or undiluted acids (e.g. detergents, petrol, paint thinner, and acetone) into the water reservoir as these substances corrode the materials used in the appliance.*
  - *Never leave the appliance unattended as long as it is in operation.*
  - *Place the appliance on a solid, even ground to ensure a safe footing.*

**ATTENTION**

- *Do not operate the appliance at temperatures below 0 °C.*

**Proper use**

This low-pressure cleaner should be used for private households only:

- for the cleaning of machines, vehicles, tools, façades, terraces, garden machines, pets etc. by means of a low-pressure water stream without additional detergents.
- with accessory parts and spare parts approved by KÄRCHER.

**Safety Devices**

**⚠ CAUTION**

- *Safety installations serve the protection of the user and may not be modified or bypassed.*

**Appliance switch**

The appliance switch prevents unintentional operation of the appliance.

**Pressure switch**

If the lever on the trigger gun is released, the pressure switch turns off the pump and the low pressure stream is stopped. If the lever is pulled, the pump is turned on again.

**Motor protection switch**

The motor protection switch switches off the device if the power consumption is high.

**Environmental protection**

**Notes about the ingredients (REACH)**

You will find current information about the ingredients at:

[www.kaercher.com/REACH](http://www.kaercher.com/REACH)



Old appliances contain valuable recyclable materials that should be recycled properly. Batteries and accumulators contain substances that must not enter the environment. Please dispose of old devices and batteries or accumulators in an environmentally friendly way.

Electrical and electronic devices often contain components which could potentially pose a danger to human health and the environment if handled or disposed of incorrectly. However, these components are necessary for the proper operation of the device. Devices marked with this symbol must not be disposed of with regular household rubbish.



The packaging material can be recycled. Please arrange for the environmentally appropriate disposal of the packaging.



Work with detergents must only be performed on liquid-tight work surfaces with a connection to the sewer system. Do not let release detergent into waters or earth.



Cleaning operations which produce oily waste water, e.g. engine washes, underbody washes, may only be carried out using washing stations equipped with an oil separator.



The extraction of water from public waters is prohibited in some countries.

## Description of the Appliance

These operating instructions describe the maximum equipment. Depending on the model, there are differences in the scopes of delivery (see packaging).

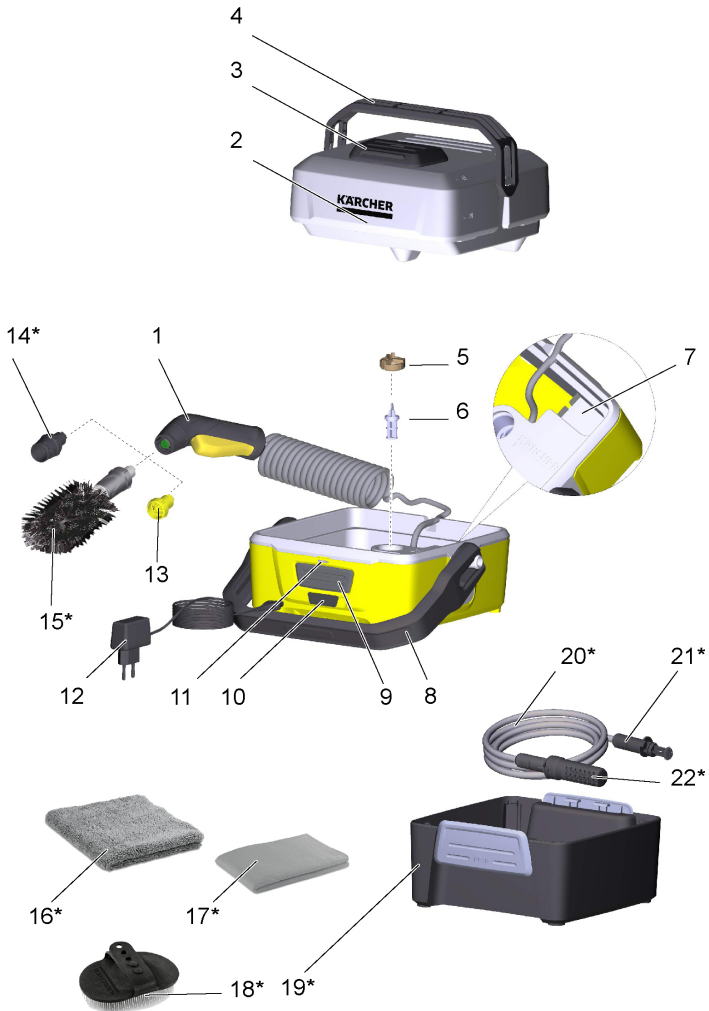

- 1 Trigger gun
- 2 Water reservoir
- 3 Water reservoir cover
- 4 Carry handle for water reservoir
- 5 Valve
- 6 Fine filter
- 7 Storage compartment for small parts
- 8 Carrying handle of the appliance
- 9 Power switch
- 10 Charging box
- 11 Battery charge indicator
- 12 Charger
- 13 Flat jet nozzle

### \* Optional accessories

- 14 Conical jet nozzle - for gentle cleaning
- 15 Universal brush
- 16 Micro fibre cloth
- 17 Viscous cloth
- 18 Fur cleaning brush
- 19 Accessories box
- 20 Suction hose
- 21 Suction hose connection
- 22 Water filter

## Blink codes

|           |   |
|-----------|---|
| — — — — — | Battery is being charged.   |
| —————     | Battery is fully charged.   |
| — — — — — | Low battery voltage warning (approx. 2 minutes operating time remaining).       |
| - - - - - | Battery discharged - device switches itself off and cannot be switched back on. |
| - - - - - | Malfunction: Motor circuit breaker has tripped (See "Troubleshooting").         |

## Scope of delivery

The scope of delivery of the device is illustrated on the packaging. Check the content for completeness upon unpacking.

In the event of missing accessories or any transport damage, please contact your dealer.

## Special accessories

Special accessories expand the possibilities of using your appliance. Please contact your KÄRCHER dealer for further information.

## Start up

- Park the appliance on an even surface.

## Charge the battery

Illustration **A**

**Note:** During the charging process, the charge/operating display blinks. Once the battery is fully charged, it will be permanently illuminated.

The charging process takes approx. 3 hours.

## Water supply

### ATTENTION

*Contamination in the water can damage the pump and the accessories.*

- Only fill or suction clear water into the tank.

### Water supply from integrated water reservoir

### ATTENTION

*Do not fill with detergents, pesticides or other additives! Do not immerse the device into water.*

*Remove the water reservoir for filling.*

Illustrations **B** - **E**

### Drawing in water from open reservoirs

Illustrations **I** - **L**

- Pull the water reservoir straight up.
- Remove the valve and fine filter using the suction hose connection or a suitable pair of pliers.
- Insert the suction hose connection into the device in place of the fine filter and fix by turning it 90°.
- Hang the suction hose with the integrated filter into the water source (e.g. rainwater drum).

### ATTENTION

*Store the valve and the fine filter safely in the storage compartment and insert them again prior to use with the water reservoir.*

## Operation

### ATTENTION

*Dry running of more than 2 minutes leads to damage to the pump. If the device does not build up pressure within 2 minutes, switch the device off and proceed in accordance with the instructions in the chapter "Troubleshooting".*

Illustration **F**

The operating time with the battery fully charged is about 15 minutes. Approx. 2 minutes before the operating time ends, the charge level indicator will start to flash.

### Operation with conical jet nozzle

#### △ CAUTION

*Do not direct the spray jet at eyes or ears.*

For gentle cleaning of fur and paws or particularly sensitive components.

Illustration **G**

- Install the conical jet nozzle.

### Operation with detergent

#### △ DANGER

*When using detergents, the material data safety sheet issued by the detergent manufacturer must be adhered to, especially the instructions regarding personal protective equipment.*

*Do not fill or suction detergent or other additives into the tank.*

- Spray the detergent sparingly on the dry surface and allow it to react, but not to dry.
- Rinse off loose dirt.

### Operation with universal brush

### ATTENTION

*Risk of damage to the paintwork*

*When working with the universal brush, it must be free of dirt or other particles.*

Illustration **H**

- Install the universal brush.

### Interrupting operation

- Release the lever on the trigger gun.
- After another 5 minutes without being pressed, the device shuts off automatically.

### Finish operation

To avoid damage:

- Remove the tank or suction hose.
- Turn on the appliance.
- Push the lever of the trigger gun until no more water is emitted.
- Release the lever on the trigger gun.
- Completely empty the tank.
- If necessary, reinsert the valve and fine filter.

### ATTENTION

*Appliances and accessories that are not completely drained can be destroyed by frost. Completely drain appliance and accessories and protect them against frost.*

## Transport

### ⚠ CAUTION

*Risk of personal injury or damage!*

*Mind the weight of the appliance during transport.*

The supplied Li-ion battery has been checked in accordance with the relevant regulations for international transport and is permitted to be transported / dispatched.

- Observe regulations for dangerous goods during transport.

### When transporting by hand

- Lift appliance by the carrying handle and carry it.

### When transporting in vehicles

- Secure the appliance against shifting and tipping over.

## Storage

### ⚠ CAUTION

*Risk of personal injury or damage!*

*Consider the weight of the appliance when storing it.*

### Storing the Appliance

- Park the machine on an even surface.
- Do not store the device at temperatures above 40°C and under 0°C.

## Care and maintenance

### ⚠ DANGER

*Risk of electric shock.*

- Turn the device off and disconnect from the charger before carrying out any tasks on the device.

### Clean valve/fine filter

Clean valve and fine filter regularly.

### ATTENTION

*Valve and filter must not be damaged.*

Illustrations **I** - **K**

- Remove the valve and fine filter using the suction hose connection or a suitable pair of pliers.
- Clean the valve and fine filter under running water.
- Reinsert the valve and fine filter.

## Troubleshooting

### ⚠ DANGER

*Turn the device off and disconnect from the charger before carrying out any tasks on the device.*

*Repair work and work on the electrical components may only be performed by an authorised customer service.*

You can rectify minor faults yourself with the help of the following overview.

If in doubt, please consult the authorized customer service.

### Appliance is not running

- Check the battery's charging state and charge it if necessary.

Motor overloaded, the motor circuit breaker has tripped.

- Turn off the appliance.
- Switch on the device and put it into operation again.

At ambient temperatures below 0°C or above 40°C, the motor circuit breaker will be tripped.

- Turn off the appliance.
- Allow device to cool down/heat up.
- Switch on the device and put it into operation again.

If the malfunction occurs repeatedly, have the device checked by the customer service.

### Pressure does not build up in the appliance

- Make sure there is enough water in the tank or water container.
- Clean valve and fine filter.

### Strong pressure fluctuations

- Clean the nozzle: Remove contamination and debris from the nozzle drill, using a needle and rinse through with water towards the front.
- Make sure there is enough water in the tank or water container.

### Appliance is leaking

- Dropwise leakage of the device is normal for technical reasons. If the leakage increases contact the authorized customer service.

## Warranty

The warranty terms published by the relevant sales company are applicable in each country. We will repair potential failures of your appliance within the warranty period free of charge, provided that such failure is caused by faulty material or defects in manufacturing. In the event of a warranty claim please contact your dealer or the nearest authorized Customer Service centre.

Please submit the proof of purchase.

Addresses can be found under:

[www.kaercher.com/dealarsearch](http://www.kaercher.com/dealarsearch)



## Technical specifications

### Electrical connection

|                                 |   |
|---------------------------------|---|
| Nominal battery voltage         | 6 V   |
| Rated power of appliance        | 45 W  |
| Protection class                | IP X4   |
| Protective class                |  |
| Charging time for empty battery | 3 h   |
| Rated charger voltage           | 100-240 V<br>1~50-60 Hz   |
| Output voltage, charger         | 9,5 V   |
| Output current, charger         | 600 mA  |
| Operating time with full charge | 15 min  |
| Max. Suction height             | 0,5 m   |

### Performance data

|                               |         |
|-------------------------------|---------|
| Working pressure              | 0,5 MPa |
| Volume, fresh water reservoir | 4 l     |
| Max. ambient temperature      | 45 °C   |
| Ambient temperature (min.)    | 0 °C    |

### Dimensions and weights

|   |        |
|---|--------|
| Length                                    | 235 mm |
| Width                                     | 277 mm |
| Height                                    | 202 mm |
| Weight, ready to operate with accessories | 6,2 kg |

### Values determined as per EN 60335-2-79

|   |          |
|---|----------|
| Sound pressure level $L_{pA}$                     | 69 dB(A) |
| Uncertainty $K_{pA}$                              | 3 dB(A)  |
| Sound power level $L_{WA}$ + Uncertainty $K_{WA}$ | 84 dB(A) |

Subject to technical changes.

## Accessories and Spare Parts

Only use original accessories and spare parts, they ensure the safe and trouble-free operation of the device. For information about accessories and spare parts, please visit [www.kaercher.com](http://www.kaercher.com).

## Customer Service

### Australia

KÄRCHER Pty. Ltd.  
40 Koornang Road  
Scoresby, Victoria 3179

1800 675 714 (Free Call)  
[www.karcher.com.au](http://www.karcher.com.au)

### New Zealand

Karcher Ltd.  
66 Allens Road,  
East Tamaki, Auckland

(09) 274-4603  
[www.karcher.co.nz](http://www.karcher.co.nz)







<http://www.kaercher.com/dealersearch>



**Alfred Kärcher GmbH & Co. KG**

Alfred-Kärcher-Str. 28 - 40

71364 Winnenden (Germany)

Tel.: +49 7195 14-0

Fax: +49 7195 14-2212