

xiaomi Outdoor Camera AW200 User Manual

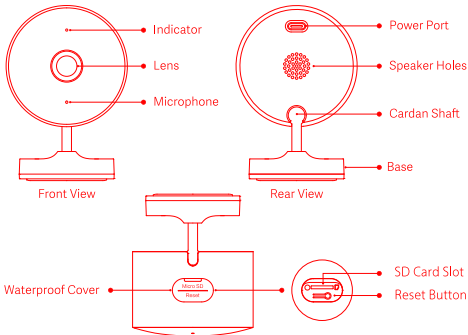

Read this manual carefully before use, and retain it for future reference.

Product Overview



Package Contents: Xiaomi Outdoor Camera AW200, charging cable, installation screws, user manual

Installation

The Xiaomi Outdoor Camera AW200 can be placed on a flat surface, such as a desk, dining table, coffee table, or TV stand, or it can be secured to a wall.

Mounting on a wall

1. Hold the base with both hands and push with your thumbs in the direction of the arrow to remove the bottom cover.

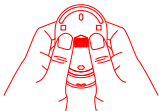

2. First use a pencil to mark the positions for the base mounting holes on the wall, then drill two holes at the marked positions. The holes should be about 6 mm in diameter and 30 mm deep.

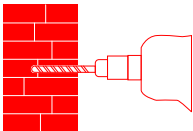
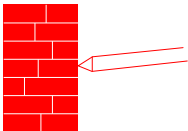

3. Insert the two plastic wall plugs into the holes.

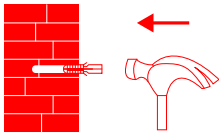

4. Make sure to position the bottom cover so that the word "UP" is facing the right way, and secure it in place by tightening the screws into the plastic wall plugs.

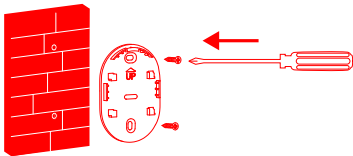

5. Slide the camera unit downwards onto the bottom cover.

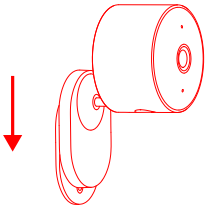

CAUTIONS:

- The wall must be able to support at least three times the total weight of the camera.
- To prevent possible injury, the camera must be securely fixed to the ceiling or wall according to the installation instructions.
- Do not install near a heat source, such as an air conditioning unit, range hood outlet, or boiler outlet.

Note: Illustrations of product, accessories, and user interface in the user manual are for reference purposes only. Actual product and functions may vary due to product enhancements.

How to Use

● Inserting a MicroSD Card

Making sure the camera is unplugged, open the waterproof cover over the microSD card slot and insert a microSD card with its contact points facing down.

Note: Unplug the camera when installing or removing the microSD card. Please use a microSD card from a qualified manufacturer (the camera supports a microSD card with a maximum capacity of 256 GB and the FAT32 format only, and a microSD card with a capacity of 64 GB and above may need to be formatted to the FAT32 format before use via "Settings > Manage Storage" on the camera's plug-in page in the Mi Home/Xiaomi Home app). It is recommended that the microSD card has a read/write speed of no less than U1/Class 10.

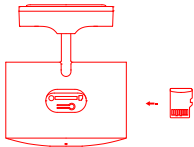

Note: After inserting or removing the microSD card, make sure to place the waterproof cover back on to avoid water getting in and affecting performance.

- Turning on
- Connect the charging cable and power adapter, and the camera will turn on automatically after it is plugged in.

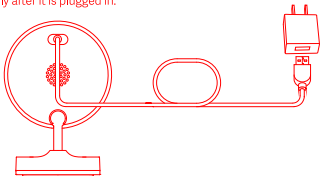

- When the camera has successfully turned on, the indicator will be lit in yellow and you will hear a voice notification.

Note: The camera does not come with a power adapter. A power adapter with an output of 5 V/1 A must be purchased separately from a qualified manufacturer.

● Indicator Status Descriptions

Yellow: Awaiting connection

Blinking yellow: Connecting to a network

Blinking blue: Connecting to a server

Blue: Connected successfully

Connecting with the Mi Home/Xiaomi Home App

This product works with the Mi Home/Xiaomi Home app*. Use the Mi Home/Xiaomi Home app to control your device, and to interact with other smart home devices.

Scan the QR code to download and install the app. You will be directed to the connection setup page if the app is installed already. Or search for "Mi Home/Xiaomi Home" in the app store to download and install it.

Open the Mi Home/Xiaomi Home app, tap "+" on the upper right, and then follow the instructions to add your device.

* The app is referred to as Xiaomi Home app in Europe (except for Russia). The name of the app displayed on your device should be taken as the default.

Note: The version of the app might have been updated, please follow the instructions based on the current app version.

Make sure the camera turns on and the network connection is stable during connecting. The indicator is blinking yellow rapidly when waiting for a connection, and turns into blue once the camera is successfully connected.

● Resetting

Press the reset button if changing the network or the Xiaomi Account connected to the camera. A voice notification will be heard once the reset is completed.

Note: Resetting the camera will not delete any data on the microSD card.



8D115F14

Precautions

- The operating temperature range for this camera is -20°C to 50°C . Do not use this camera in environments with temperatures above or below the specified operating range.
- This camera is a precision electronic product that has an IP65 waterproof rating. To ensure its normal operation, do not expose it to extremely humid environments or locations where it is likely to get water on it.
- To improve the camera's performance, please do not place it where its lens faces or is next to a reflective surface, such as glass and white walls, as this will cause the image to appear overly bright in areas close to the camera and darker in areas further away, or may cause the camera to produce white images.
- Make sure the camera is installed in an area with good Wi-Fi reception. Do not install the camera near microwave ovens and other objects or places that affect its Wi-Fi signal.
- If the charging cable is damaged or broken, it must be replaced with a genuine charging cable purchased from the manufacturer or the official channels to avoid safety hazards.

Specifications

Name: Xiaomi Outdoor Camera AW200	Operating Temperature: -20°C to 50°C
Model: MJSXJ05HL	Item Dimensions: 70 × 64 × 92 mm
Rated Input: 5 V $\bar{\text{---}}$ 1 A	Wireless Connectivity: Wi-Fi IEEE 802.11 b/g/n 2.4 GHz
Aperture: F1.6	Storage: MicroSD card
Video Codec: H.265	Compatible with: Android 8.0 & iOS 12.0 or above
Lens Viewing Angle: 120°	Operation Frequency: 2412-2472 MHz
Resolution: 1920 × 1080	Maximum Output Power: < 20dBm

WARRANTY NOTICE

As a Xiaomi consumer, you benefit under certain conditions from additional warranties. Xiaomi offers specific consumer warranty benefits which are in addition to, and not instead of, any legal warranties provided by your national consumer law. The duration and conditions related to the legal warranties are provided by respective local laws. For more information about the consumer warranty benefits, please refer to Xiaomi's official website <https://www.mi.com/en/service/warranty/>. Except as prohibited by laws or otherwise promised by Xiaomi, the after-sales services shall be limited to the country or region of the original purchase. Under the consumer warranty, to the fullest extent permitted by law, Xiaomi will, at its discretion, repair, replace or refund your product. Normal wear and tear, force majeure, abuse or damage caused by the user's negligence or fault are not warranted. The contact person for the after-sale service may be any person in Xiaomi's authorized service

network, Xiaomi's authorized distributors or the final vendor who sold the products to you. If in doubt please contact the relevant person as Xiaomi may identify.

The present warranties do not apply in Hong Kong and Taiwan.

Products which were not duly imported and/or were not duly manufactured by Xiaomi and/or were not duly acquired from Xiaomi or a Xiaomi's official seller are not covered by the present warranties. As per applicable law you may benefit from warranties from the non-official retailer who sold the product. Therefore, Xiaomi invites you to contact the retailer from whom you purchased the product.

WEEE Information



All products bearing this symbol are waste electrical and electronic equipment (WEEE as in directive 2012/19/EU) which should not be mixed with unsorted household waste. Instead, you should protect human health and the environment by handing over your waste equipment to a designated collection point for the recycling of waste electrical and electronic equipment, appointed by the government or local authorities. Correct disposal and recycling will help prevent potential negative consequences to the environment and human health. Please contact the installer or local authorities for more information about the location as well as terms and conditions of such collection points.

EU Declaration of Conformity



Hereby, Tianjin Hualai Technology Co., Ltd. declares that the radio equipment type [MJSXJ05HL] is in compliance with Directive 2014/53/EU. The full text of the EU declaration of conformity is available at the following internet address:

<http://www.mi.com/global/service/support/declaration.html>

UK Declaration of Conformity



Hereby, [Tianjin Hualai Technology Co., Ltd.] declares that the radio equipment type [MJSXJ05HL] is in compliance with Radio Equipment Regulations 2017 . The full text of the UK declaration of conformity is available at the following internet address:

<https://www.mi.com/uk/service/support/declaration.html>

It is recommended to use LPS power supply, or the PS Level of power output part is less than PS2.

Under normal use of condition, this equipment should be kept a separation distance of at least 20cm between the antenna and the body of the user.

Manufactured for: Xiaomi Communications Co., Ltd.

Manufactured by: Tianjin Hualai Technology Co., Ltd.

(a Mi Ecosystem company)

Address: 8/F, Huaqiao Chuangye Building, No. 10 Jinping Road, Ya'an Road, Nankai District, Tianjin, China

For further information, please go to www.mi.com

User Manual Version: V1.0