

# User Manual *LivingColors* Iris



## Getting started with your *LivingColors*

### Unpacking and Installing

If you unpack a *LivingColors*, the product is already linked to the remote control. You only need to plug it into the power system, put the batteries into the remote control and start the experience!

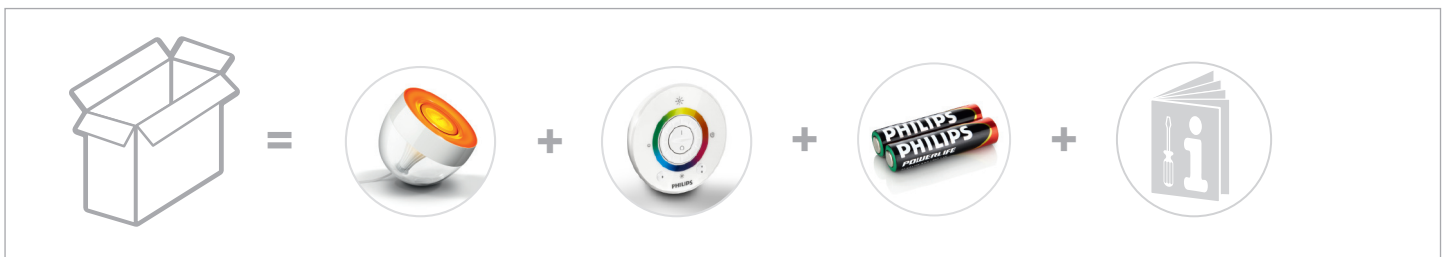

**Step 1:** Place your *LivingColors* in a selected location on a flat and stable surface and direct it towards the wall (the optimal distance is 50 cm).

**Step 2:** Plug your *LivingColors* into the power system.



**Step 3:** Insert the two AAA-batteries by sliding open the battery compartment (+ and – as indicated) on the back of the remote control.



## Basic functionality

### Switch the *LivingColors* “On” or “Off”:

Your *LivingColors* can be switched “On” and “Off” by using the “I”- and “0”-button on the remote control. If you switch the *LivingColors* “Off”, it will remember your last setting for the next time you use it.

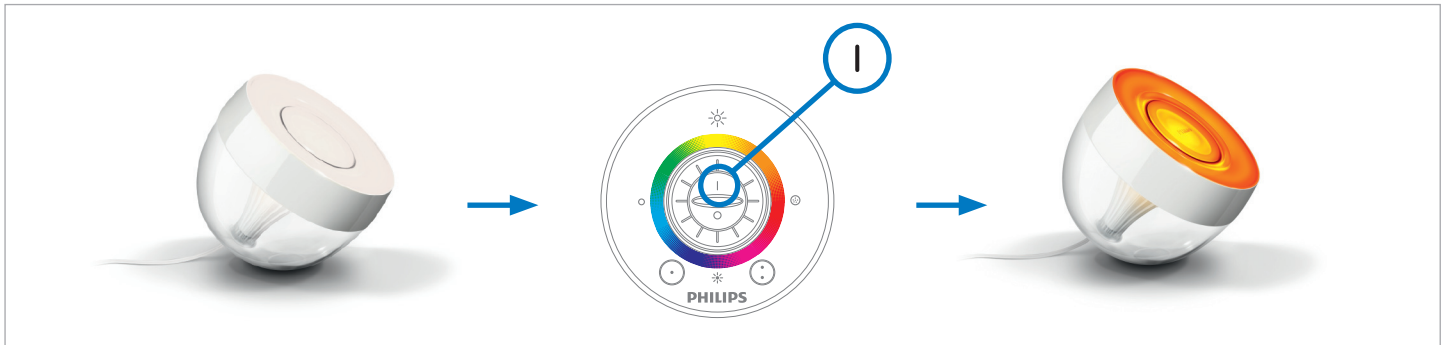

### Colour selection:

To let your *LivingColors* change to whatever colour you like, simply rotate the colour wheel (rotary wheel at the centre of the remote control) until you have found the right colour. If you rotate the wheel quickly, the colours will change quickly. If you rotate slowly, the colours will change slowly and you can really fine-tune them.

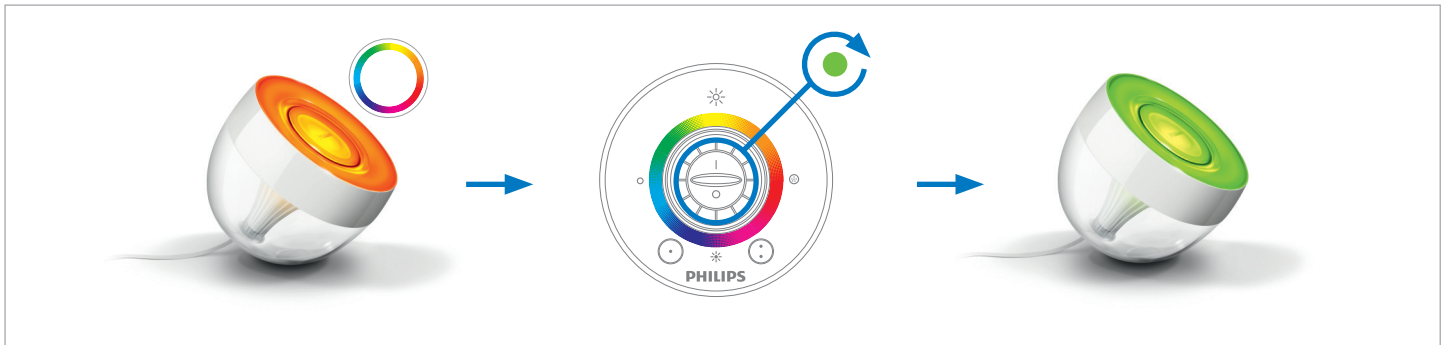

### Dimming:

Increase or decrease the light intensity by pressing the colour wheel on the top and bottom position.

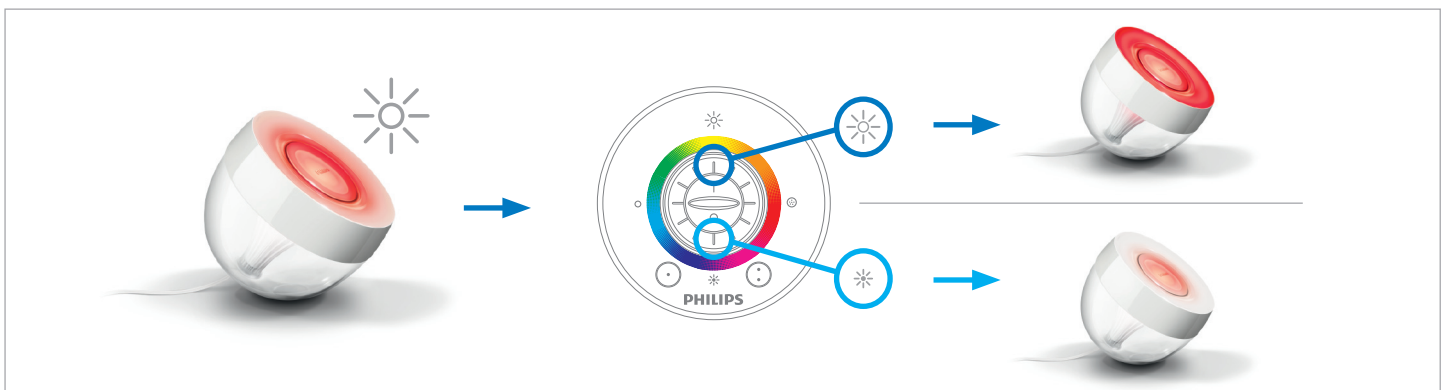

## Colour intensity (saturation):

If you want to add more white to your current colour or make your colour intense (saturated) again, you can easily change the colour intensity (saturation). Just press the colour wheel on the left (more white) or right (more colour) position. If you keep pressing on the left position, you will ultimately reach white.

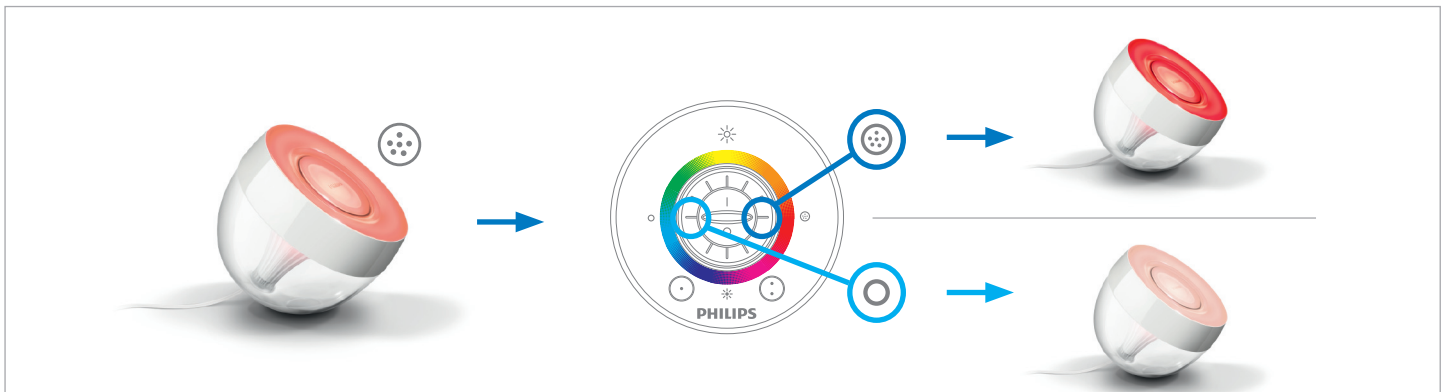

## Discovering your *LivingColors*

### Extended functionality

#### Automatic Colour Change Mode:

You can also let your *LivingColors* change colours automatically. You can even choose how fast you want it to go through the whole colour spectrum.

Sweep your finger clockwise around the colour wheel (one full circle, 360°) and briefly press on "I" ("On") to get into the Automatic Colour Change Mode. The *LivingColors* will now start looping through the colours.

Change the speed of the Automatic Colour Change Mode stepwise (20 steps in total) by sweeping the colour wheel clockwise (to go faster) or anticlockwise (to go slower) for 90° during the time that the Automatic Colour Change Mode is on.

While the Automatic Colour Change Mode is on, you can also adjust the saturation and brightness of the colours. To switch back to the one colour mode, sweep your finger clockwise around the colour wheel and press "0" ("Off"). Alternatively, you can switch lights off "0" and on "I" again.

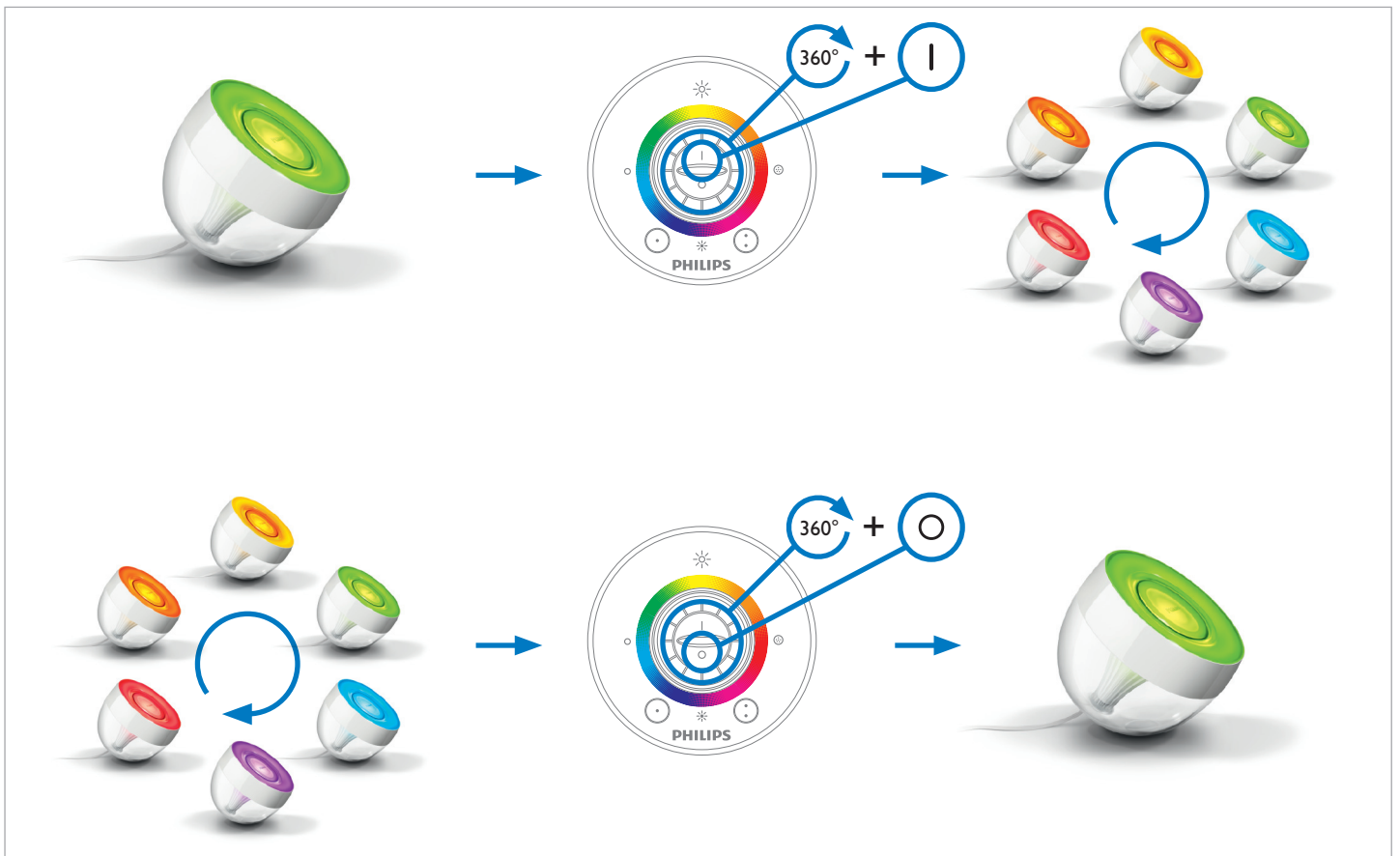

## Favourite Buttons:

With your *LivingColors* you can store your two favourite colours for easy recall.

To store your favourite colour, first select it using the colour wheel (and dimming/colour intensity) on the remote control. Then press and hold one of the Favourite Buttons until the LED indicator (hidden underneath the intensity up symbol) blinks (this will take +/- 5 seconds). Your favourite colour is now stored under the Favourite Button (1 or 2) that you have pressed. Whenever you want to go back to your favourite colour, just press one of the Favourite Buttons. The *LivingColors* will now show your favourite colour.

You can also store a particular Automatic Colour Change Mode in this way.

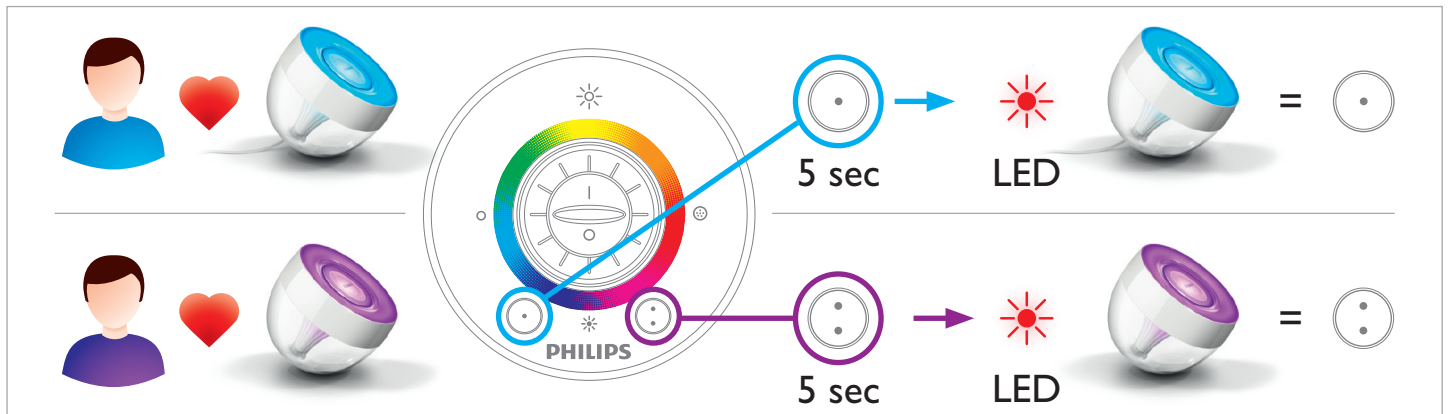

## How to use multiple *LivingColors*?

### Connecting multiple Philips *LivingColors*

If you have multiple *LivingColors* at home, you can all use them with just one remote control. To connect the different *LivingColors* to the same remote control, follow the instructions below.

Hold the remote control close against the Philips logo on the lens of the product, then press and hold the "I" button. The product will flash 3 times. Hold the "I"-button until the *LivingColors* displays a green light. It is now connected to the remote control.

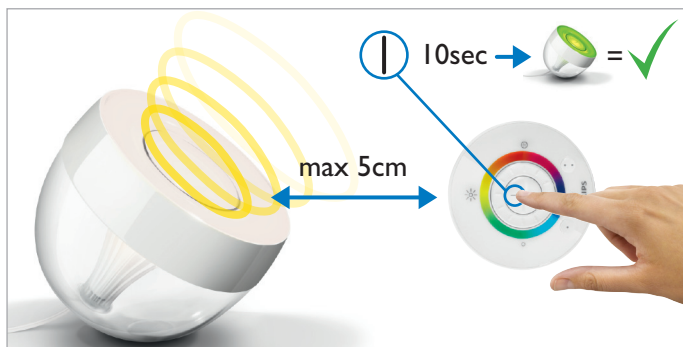

Repeat this procedure for every product you want to add to this remote control. After connecting all of the products to the remote control, you will be able to let them all change colour at the same time. The same colour will be displayed by all of your *LivingColors* products by only using one remote control.

Note: You can only connect/add other  products to your remote control (50 products maximum). If the logo is not on the packaging/product, the product cannot be added to the system. For the *LivingAmbiance* luminaires, please make sure that you connect both the coloured light (top of the shade) and white light (at the foot or ceiling plate).

## Disconnecting multiple Philips *LivingColors* (optional)

If you connect another remote control to the same luminaire, it will be automatically disconnected from the first remote control (unless the two remotes were connected first - see further).

Alternatively, you can disconnect a remote control from a luminaire as follows: Hold the remote control against the Philips logo on the lens of the product, then press and hold the "0"-button. The product will flash 3 times. Hold the "0"-button until the *LivingColors* is switched off automatically. The *LivingColors* is now disconnected.

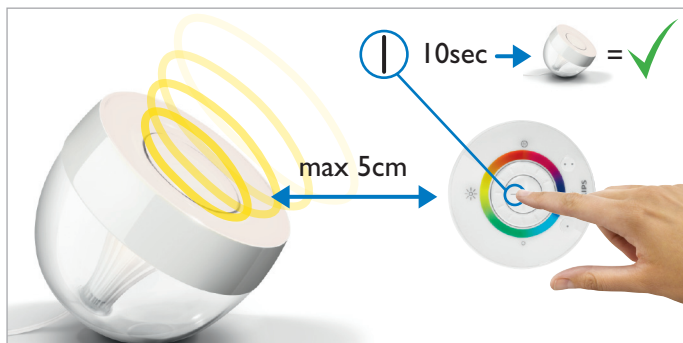

## Connecting additional Remote Controls

You can control the same products with several remote controls. This is convenient if, for example, you want to leave one remote control in the kitchen and another one in the living room.

**Step 1:** Always reset the additional remote control first. Open its battery compartment and press the RESET button for a few seconds. The LED indicator will blink once (hidden underneath the intensity up symbol). The remote control has now been reset.



**Step 2:** Hold the additional remote control close to your current remote (the "I"-buttons pointing at each other). Press the "I" buttons simultaneously on both remotes while the LED indicators on the remote controls blink intermittently. When they stop blinking, the two remotes are connected to the same network.

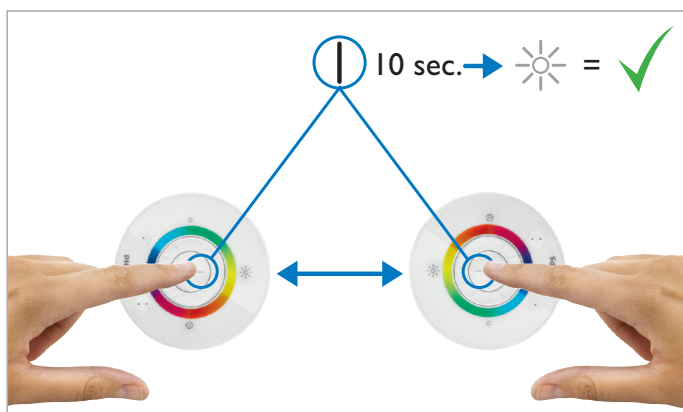

**Step 3:** You still need to connect the additional remote to the *LivingColors*. If you have two round remotes, you can do it easily by repeating the above action (bring two remotes close, then press on "I" until they stop blinking intermittently). This action needs to be done directly after connection of the additional remote control. The additional remote is now connected to the same lights as the first remote control.

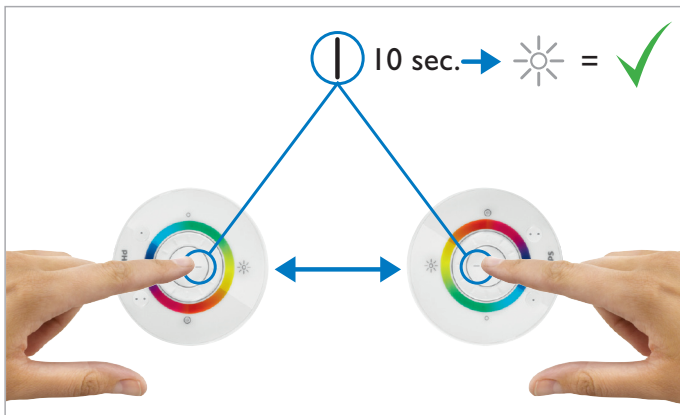

## What to do if your *LivingColors* is not responding properly?

### Solution 1: Perform *LivingColors* and battery check

1. Unplug your *LivingColors* from the power network, plug it back in and check whether it reacts to the remote control.
2. Remove and reinsert batteries. The batteries should be correctly placed and inserted (+ and -). Check if batteries are charged.
3. If the remote control is still not working, try replacing the batteries.
4. If necessary, connect the remote control to the *LivingColors* again (same way as connecting multiple *LivingColors* to one remote control).

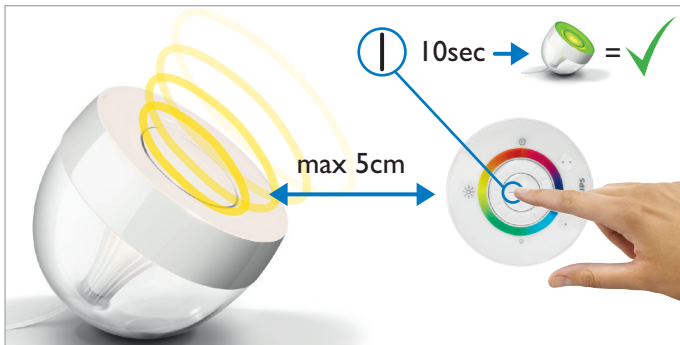

### Solution 2: Perform a channel switch

In rare cases, problems with the connection between your *LivingColors* and the remote control could be caused by heavy traffic on the wireless network (e.g. a wireless router). Try moving the light away from the router or follow below procedure. Make sure that all *LivingColors* connected to the remote control are switched on, otherwise they will not respond after this action.

For the round remote control (with mechanical wheel), simultaneously press the "I"-button and "Favourite 2"-button for 5 seconds.

For the round remote control (with touch control), simultaneously press the "I"-button and "Scene 3"-button for 5 seconds.

For the long oval remote control, simultaneously press the "0"-button and saturation up button for 5 seconds.

The *LivingColors* will show an orange and then a green light for 1 second and then they revert to their previous setting. White lights (*LivingWhites*) first blink once, then rapidly blink twice and revert to previous setting.



### Solution 3: Reset the remote control

Open the remote control's battery compartment and press the RESET button for a few seconds (e.g. with a paper clip). Make sure that the batteries are in. After this action, you need to reconnect your *LivingColors* to the remote control.

