

Rohnson[®]

INSTRUCTION MANUAL

TABLE FAN 40CM R-8371

AC220V-240V / 50Hz 45W



**BEFORE OPERATING THIS PRODUCT, READ, UNDERSTAND,
AND FOLLOW THESE INSTRUCTIONS.**

BEFORE FIRST USE

General Safety Instructions

Read this instruction manual thoroughly before using the appliance and save it for future reference and if it is necessary pass the instruction manual on to a third party.

WARNING

When using electrical appliance, basic safety precautions should always be followed to reduce the risk of fire, electrical shock and personal injury.

Handle carefully the motor, the plastic fan blades, and other fan parts when assembling or disassembling them, to avoid injury and/or damage.

- 1) This product is intended for general domestic use. Do not use the product for any other purpose.
- 2) Keep the product out of the reach of children and pets. This product is not intended for use by children.
- 3) Do not leave the product unattended while it is in use, especially when children are present.
- 4) Always unplug the product from the electrical outlet when it is not in use.
- 5) Always operate the product on a flat, steady, and stable surface to avoid it overturning.
- 6) Do not hang or wall-mount the product.
- 7) Do not place the product outside or near an open window. Rain, snow, and other weather elements may create an electrical hazard.
- 8) Keep the power cord and product away from heated surfaces.
- 9) Always unplug the product from the electrical outlet when cleaning it.
- 10) Do not plug/unplug the product into/from the electrical outlet with a wet hand.
- 11) Never insert fingers or any other object through the fan guards.
- 12) Never drop or insert objects into any opening of the product
- 13) Do not attempt to open any part of the motor housing, as a risk of electrical shock may exist.
- 14) Never operate the product without the fan guards in place, as serious personal injury may result.
- 15) Do not allow the power cord to hang (i.e., over the edge of a table or counter) where it may be tripped over
- 16) or pulled.
- 17) Do not operate product if the power cord is cut, damaged, or if the wires are exposed.
- 18) Do not immerse or expose the motor housing, power cord, or plug to water or other liquids.
- 19) Disconnect the plug (do not pull on the power cord) from the electrical outlet.
- 20) Do not put any stress on the power cord where it connects to the product, as the power cord could fray and break.

- 21) Do not operate the product if it has a damaged power cord or plug, malfunctions, is dropped, or damaged. This product has no user – serviceable parts. Do not attempt to examine or repair this product yourself. Qualified service personnel should perform any servicing.
- 22) This product is intended for indoor, non-commercial, non-industrial; household use only. Do not use outdoors.
- 23) This appliance is not intended for use by persons (including children) with reduced physical, sensory or mental capabilities, or lack of experience and knowledge, unless they have been given supervision or instruction concerning use of the appliance by a person responsible for their safety.
- 24) Children should be supervised to ensure that they do not play with the appliance.

OVERVIEW THE FAN

1. Front Grill
2. Blade Lock Nut
3. Blade
4. Grill Lock Nut
5. Back Grill
6. Motor
7. Front Motor Cover
8. Motor Cover
9. Oscillation Button
10. Fixed Nut
11. Fixed Screw
12. Motor Holder
13. Speed Button
14. Base
15. Base Fixed Screw

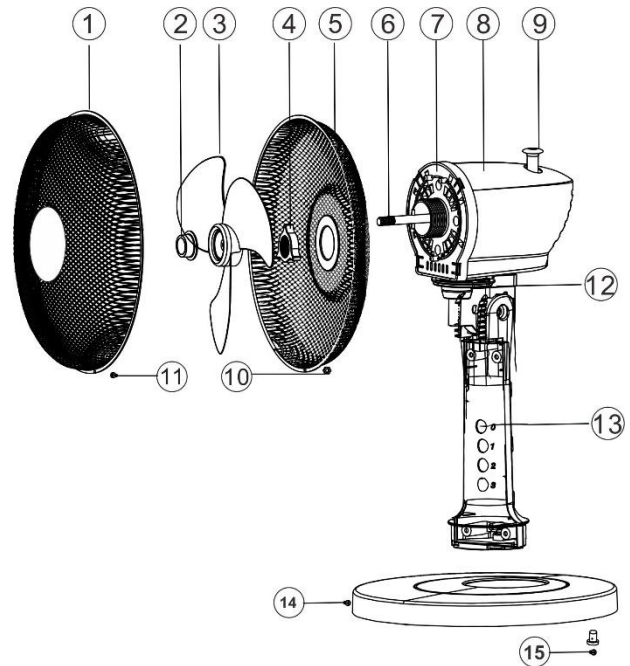

ASSEMBLING THE FAN

1. Take off all the appliance parts out of the packaging and remove all packaging materials and inserts.
2. Take the main body (13), put it into the base (14), and fixed by base fixed screw (15)
3. Take the back grill (5), put it on the motor (6), and fixed by grill lock nut (4)
4. Take the blade (3), put it into the motor (6), and fixed by blade lock nut (2)
5. Take the front grill (1), put it to match the back grill (5). And fixed by fixed screw (11) and fixed nut (10)

On / Off and Speed Control

The ON/OFF and Speed is controlled by the buttons in the main body.

- 0- The Fan is switched Off
- 1- The Fan operates at the Low speed
- 2- The Fan operates at the middle speed
- 3- The Fan operates at the high speed

Oscillation Adjustment

Push the oscillation control to turn on the oscillation function, pull the oscillation control to turn it off. (Fig.7)

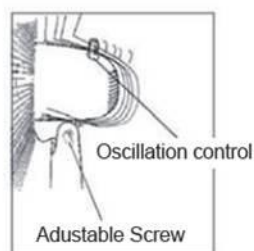

Cleaning

Before cleaning the appliance always disconnect the power plug from the receptacle.

- The appliance, the power cord and the power plug should not be immersed in water or other liquids when you are cleaning them. Clean them with a dry cloth.

- If it is very dirty, the outside of the appliance can be wiped carefully with a moist cloth and then dried carefully. Make sure that no moisture penetrates the interior of the appliance.
- Do not use any harsh cleaners, steel brushes, scouring powder or other hard objects to clean the appliance as these can cause scratches on the surfaces.
- Clean the appliance regularly.
- Never use solvents, benzene or oil-based cleaners as these can damage the housing.
- Re-tighten visible screw connections on the appliance regularly in order to ensure that the device is functioning properly.



IMPORTANT INFORMATION FOR CORRECT DISPOSAL OF THE PRODUCT IN ACCORDANCE WITH EC DIRECTIVE 2002/96/EC.

At the end of its working life, the product must not be disposed of as urban waste. It must be taken to a special local authority differentiated waste collection center or to a dealer providing this service. Disposing of a household appliance separately avoids possible negative consequences for the environment and health, deriving from inappropriate disposal and enables the constituent materials to be recovered to obtain significant savings in energy and resources. As a reminder of the need to dispose of household appliances separately, the product is marked with a crossed-out wheeled dustbin.

